

### SPECIFICATIONS:

**MODEL NUMBER:** 8025-933-289

**PUMP DESIGN:** Positive Displacement 3 Chamber Diaphragm Pump

**CHECK VALVE:** (1-Way Operation) Prevents Reverse Flow

**CAM:** 3.0 Degree

**MOTOR:** Permanent Magnet, P/N 11-195-01, Thermally Protected

**VOLTAGE:** 115 VAC Nominal

**PRESSURE SWITCH:** Adjustable Shut-Off (Range 80-100 PSI)

Factory Set @ 95 PSI, Turn On 75 PSI  $\pm$  5 PSI

**LIQUID TEMPERATURE:** 180 Degrees Fahrenheit (82 Degrees Centigrade) Max.

**PRIME:** Self-Priming Up To 12 Ft. Vertical,  
Max. Inlet Pressure 30 PSI (2.1 Bar)

**PORTS:** 3/8"-18 NPT Female

**MATERIAL OF CONSTRUCTION:**

**PLASTICS-** Nylon

**VALVES-** EPDM

**DIAPHRAGM-** Santoprene

**FASTENERS-** Zinc Plated Steel

**NET WEIGHT:** 5.3 Lbs (2.4 Kg)

**DUTY CYCLE:** Intermittent (See Temperature Rise Chart)

**APPROVALS:** NSF/UL/CSA Listed

**TYPICAL APPLICATIONS:** Water Delivery

### DIMENSIONS:

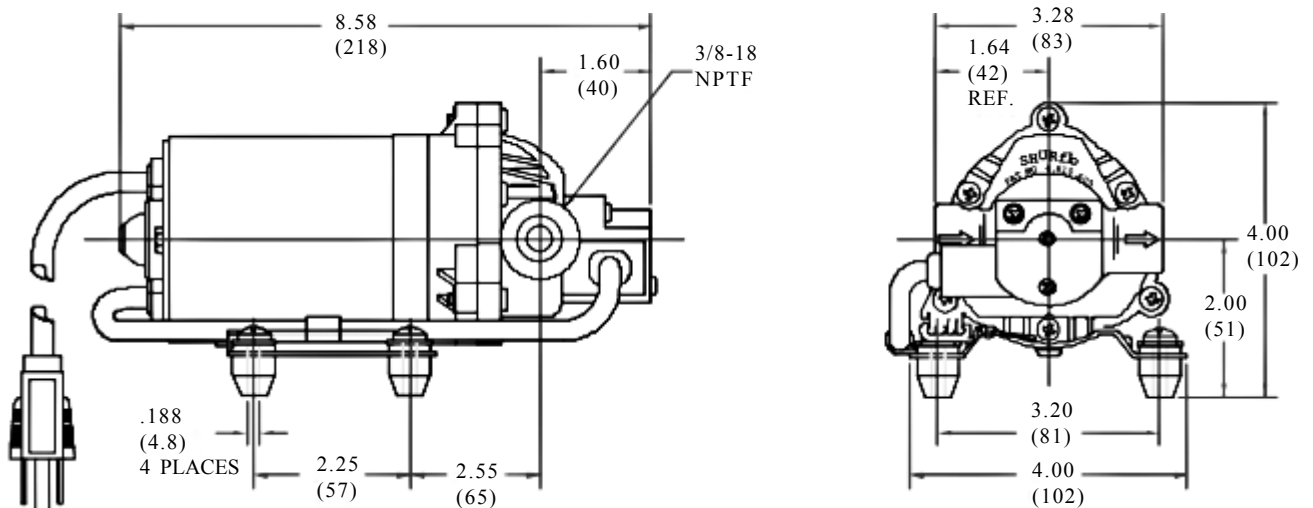

### TEMPERATURE RISE

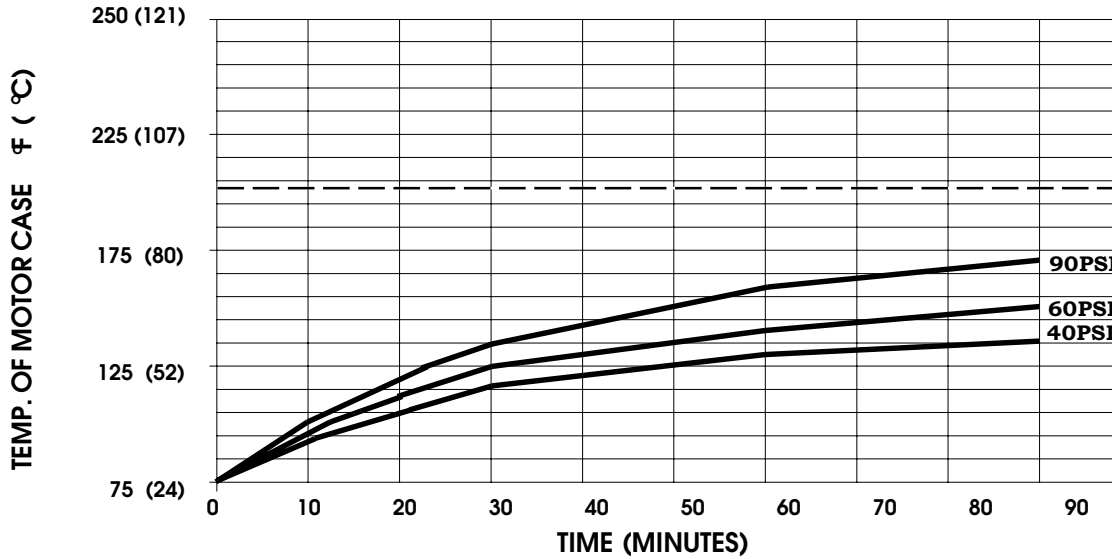

THIS GRAPH IS FOR USE AS A DESIGN GUIDE. IT IS BASED ON RUNNING CONTINUOUSLY WITH AN AMBIENT TEMPERATURE OF 75° F IN STILL AIR. THE THERMAL BREAKER WILL OPEN WHEN THE CASE TEMPERATURE REACHES 203° F.

[----- TRIP POINT OF THERMAL PROTECTOR]

### TYPICAL PERFORMANCE

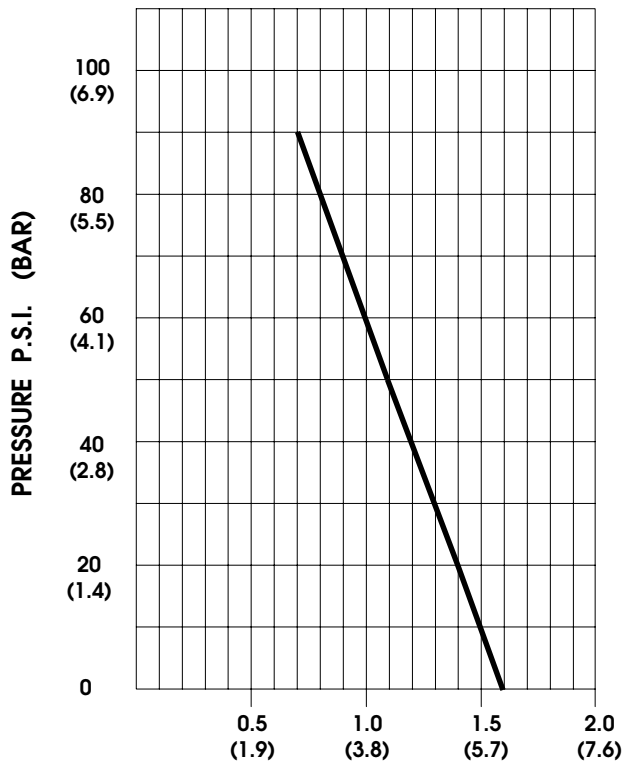

PRESSURE (PSI)	FLOW (GPM/LIT)	RPM MIN/MAX	CURRENT (AMPS)	VOLTAGE (VOLTS)
OPEN	1.60/6.0	2100/2185	0.36	115VAC
10	1.50/5.7	2045/2105	0.42	"
20	1.42/5.4	1965/2020	0.48	"
30	1.34/5.1	1895/1945	0.55	"
40	1.26/4.8	1825/1880	0.61	"
50	1.19/4.5	1760/1815	0.67	"
60	1.13/4.3	1705/1755	0.73	"
70	1.06/4.0	1645/1705	0.79	"
80	0.93/3.5	1595/1650	0.84	"
90	0.68/2.6	1550/1600	0.90	"

*-SPECIFICATIONS SUBJECT TO CHANGE WITHOUT NOTICE.*

*-ALL DATA BASED ON TESTING WITH WATER AT AMBIENT TEMPERATURE.*