

SPECIFICATIONS:

- MODEL NUMBER:** 8005-991-820
- PUMP DESIGN:** Positive Displacement 3 Chamber Diaphragm Pump
- CAM:** 2.5 Degree
- MOTOR:** Permanent Magnet, P/N 11-237-00
- VOLTAGE:** 24VAC Nominal
- PRESSURE SWITCH:** None
- LIQUID TEMPERATURE:** 180 Degrees Fahrenheit (82 Degrees Centigrade) Max.
- PORTS:** 3/8"-18 NPT Female
- MATERIAL OF CONSTRUCTION:**
 - PLASTICS-** Nylon
 - VALVES-** EPDM
 - DIAPHRAGM-** Santoprene
 - FASTENERS-** Stainless Steel
- NET WEIGHT:** 5.8 Lbs (2.6 Kg)
- DUTY CYCLE:** Continuous (See Temperature Rise Chart)
- APPROVALS:** NSF Listed
- TYPICAL APPLICATIONS:** R.O. Booster Pump
- BYPASS:** 45 PSI

DIMENSIONS:

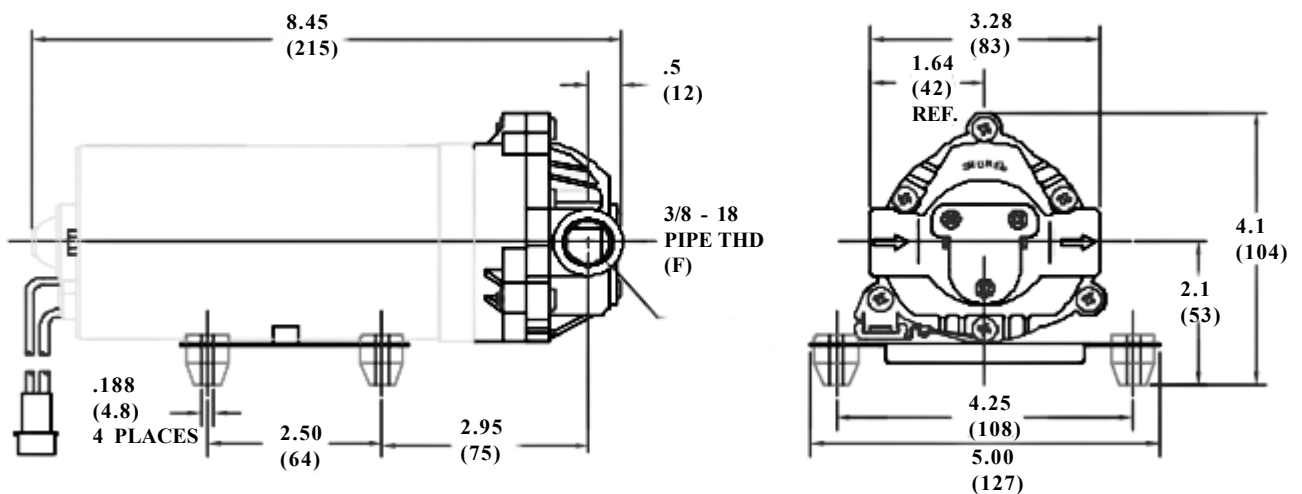

TEMPERATURE RISE

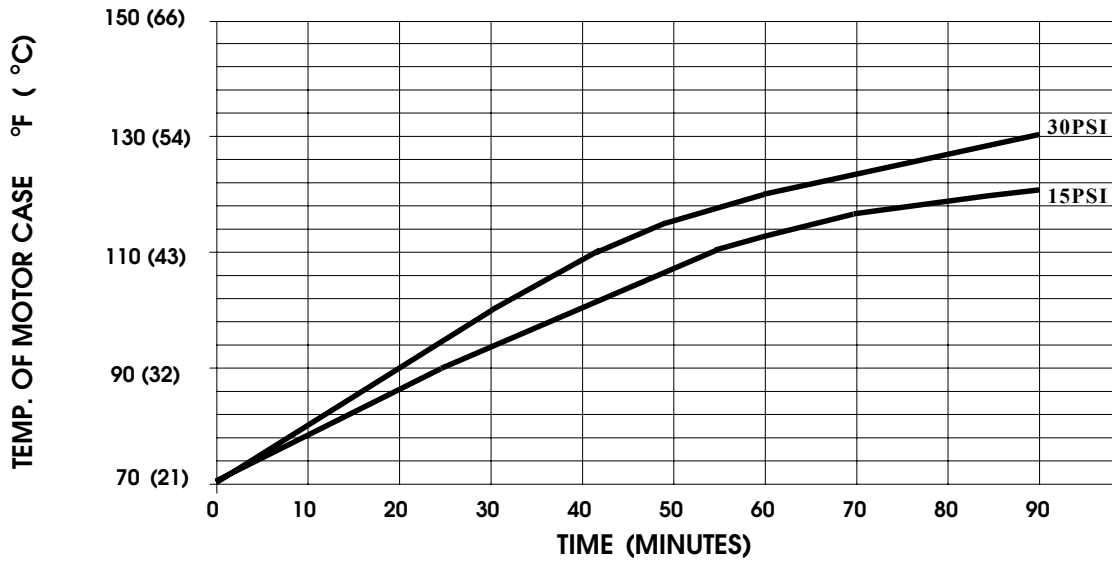

THIS GRAPH IS FOR USE AS A DESIGN GUIDE. IT IS BASED ON RUNNING CONTINUOUSLY WITH AN AMBIENT TEMPERATURE OF 70 °F IN STILL AIR.

TYPICAL PERFORMANCE

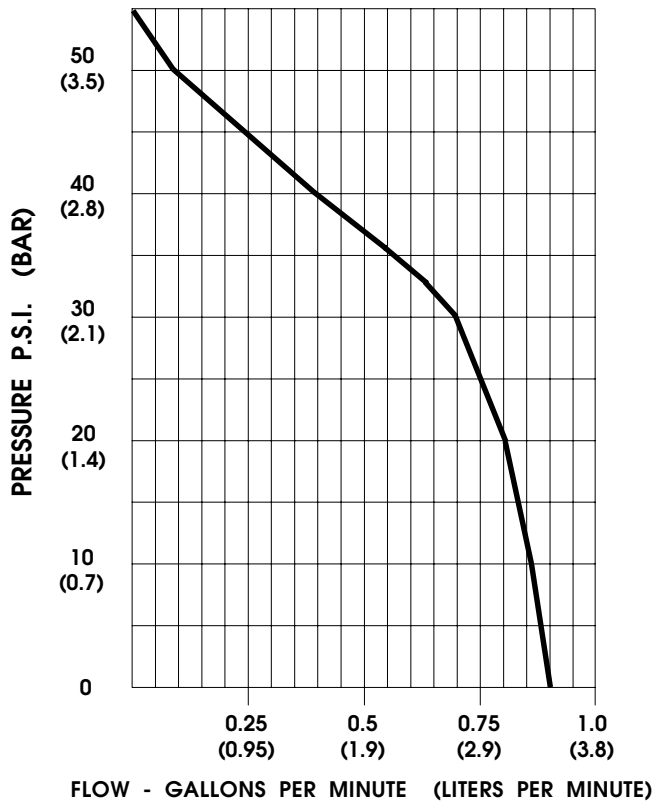

PRESSURE (PSI)	FLOW (GPM/LIT)	RPM MIN/MAX	CURRENT (AMPS)	VOLTAGE (VOLTS)
OPEN	0.90/3.4	1550/1570	1.0	24VAC
10	0.86/3.3	1440/1470	1.2	"
20	0.81/3.1	1400/1410	1.4	"
30	0.68/2.6	1350/1370	1.6	"
40	0.37/1.4	1315/1320	1.8	"
50	0.08/0.3	1270/1280	2.0	"

**-SPECIFICATIONS SUBJECT TO CHANGE WITHOUT NOTICE.
-ALL DATA BASED ON TESTING WITH WATER AT AMBIENT TEMPERATURE.**