

SPECIFICATIONS:

MODEL NUMBER: 2093-204-114, WHISPER KING
PUMP DESIGN: Positive Displacement 3 Chamber Diaphragm Pump
CHECK VALVE: (1-Way Operation) Prevents Reverse Flow
CAM: 3.5 Degree
MOTOR: Permanent Magnet, P/N 11-192-00, Thermally Protected
VOLTAGE: 12 VDC Nominal
PRESSURE SWITCH: Adjustable from 30-50 PSI. Factory Set @ 45 PSI Shut-Off,
 Turn On 25 ± PSI
LIQUID TEMPERATURE: 130 Degrees Fahrenheit (54 Degrees Centigrade) Max.
PRIME: Self-Priming Up To 11 Ft. Vertical,
 Max. Inlet Pressure 30 PSI (2.1 Bar)
PORTS: 1/2" - 14 Male Parallel Thread
MATERIAL OF CONSTRUCTION:
PLASTICS- Polypropylene
VALVES- EPDM
DIAPHRAGM- Santoprene
FASTENERS- Zinc Plated Steel
NET WEIGHT: 4.0 Lbs (1.8 Kg)
DUTY CYCLE: Intermittent (See Temp. Rise Chart)
TYPICAL APPLICATIONS: Potable Water
APPROVALS: CSA Recognized Component

DIMENSIONS:

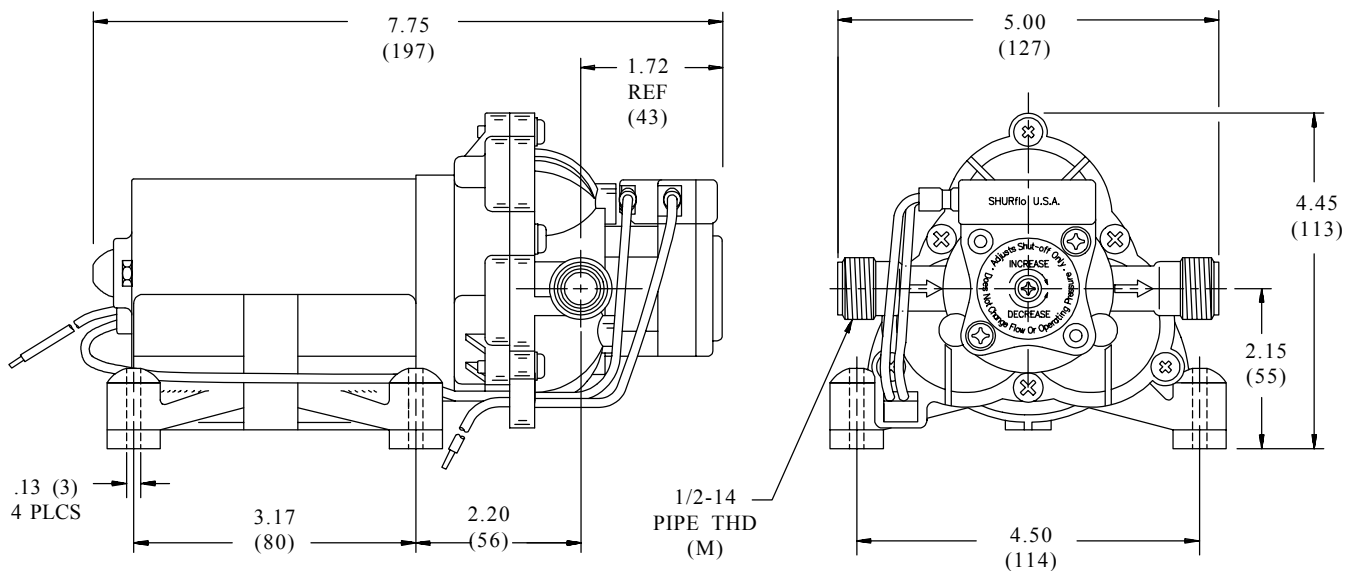

TEMPERATURE RISE

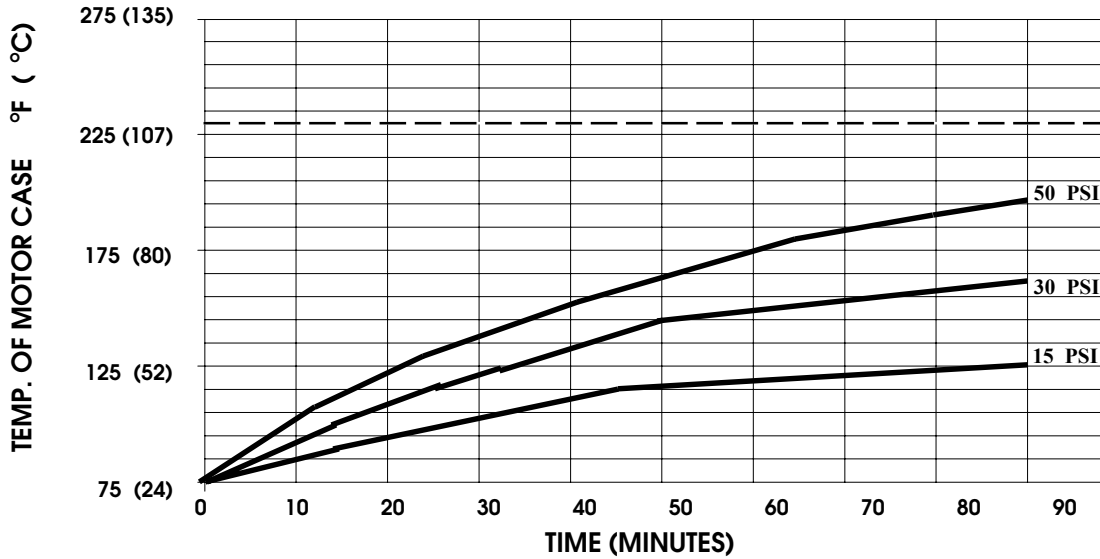

THIS GRAPH IS FOR USE AS A DESIGN GUIDE. IT IS BASED ON RUNNING CONTINUOUSLY WITH AN AMBIENT TEMPERATURE OF 75° F IN STILL AIR. THE THERMAL BREAKER WILL OPEN WHEN THE CASE TEMPERATURE REACHES 230° F.

[---- TRIP POINT OF THERMAL PROTECTOR]

TYPICAL PERFORMANCE

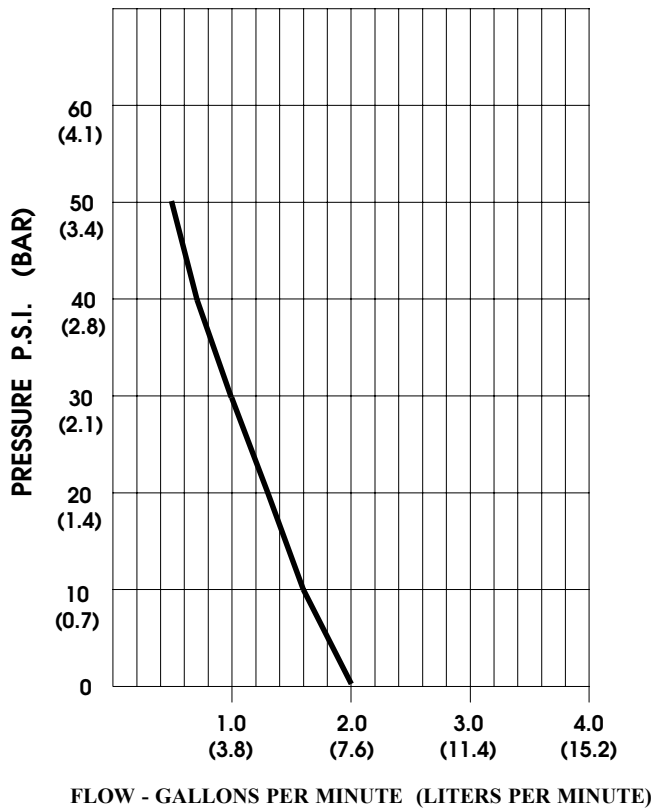

PRESSURE (PSI)	FLOW (GPM/LIT)	RPM MIN/MAX	CURRENT (AMPS)	VOLTAGE (VOLTS)
OPEN	2.00/7.0	1000/1015	1.7	12 VDC
10	1.57/5.9	895/900	2.4	"
20	1.28/4.8	775/780	3.3	"
30	0.97/3.7	640/655	4.2	"
40	0.86/3.3	450/510	4.5	"
50	0.50/1.9	415/470	5.2	"

-SPECIFICATIONS SUBJECT TO CHANGE WITHOUT NOTICE.

-ALL DATA BASED ON TESTING WITH WATER.