

SPECIFICATIONS:

MODEL NUMBER: 2088-343-170

PUMP DESIGN: Positive Displacement 3 Chamber Diaphragm Pump

CHECK VALVE: None

CAM: 3.0 Degree

MOTOR: Permanent Magnet, P/N 11-174-01, Fuse Protected w/Power Switch

VOLTAGE: 12 VDC Nominal

PRESSURE SWITCH: None, 1/4" Fitting Adapter

LIQUID TEMPERATURE: 170 Degrees Fahrenheit (77 Degrees Centigrade) Max.

PRIME: Self-Priming Up To 9 Ft. Vertical,
Max. Inlet Pressure 30 PSI (2.1 Bar)

PORTS: 1/2" - 14 Male Parallel Thread

MATERIAL OF CONSTRUCTION:

PLASTICS- Polypropylene

VALVES- Viton

DIAPHRAGM- Santoprene

FASTENERS- Zinc Plated Steel

NET WEIGHT: 4.8 Lbs (2.17 Kg)

DUTY CYCLE: Intermittent (See Temperature Rise Chart)

TYPICAL APPLICATIONS: Agricultural Spraying

DIMENSIONS:

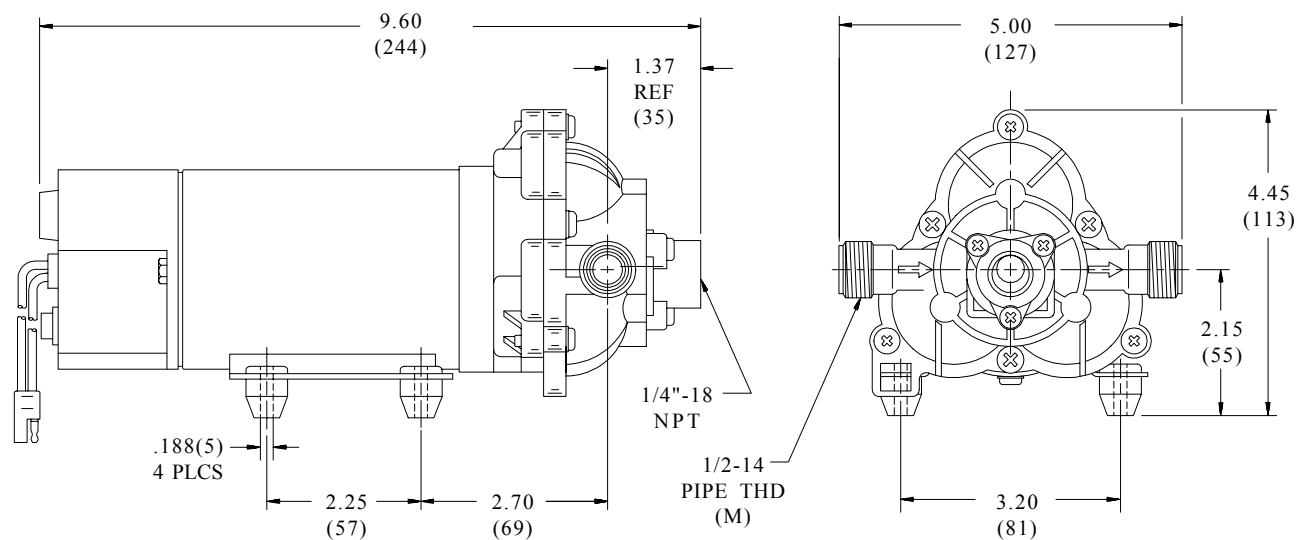

TEMPERATURE RISE

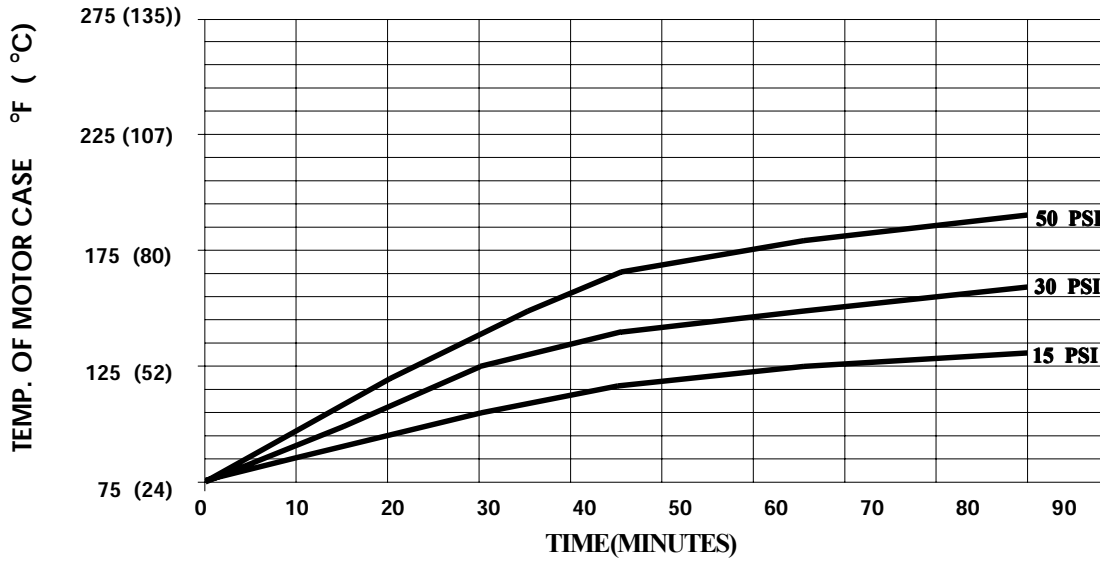

THIS GRAPH IS FOR USE AS A DESIGN GUIDE. IT IS BASED ON RUNNING CONTINUOUSLY WITH AN AMBIENT TEMPERATURE OF 75°F IN STILL AIR.

TYPICAL PERFORMANCE

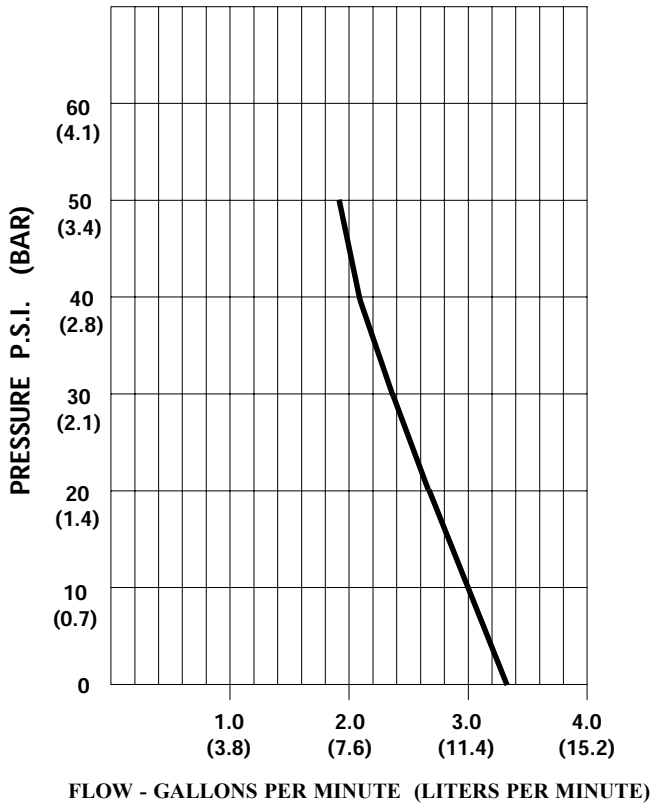

PRESSURE (PSI)	FLOW (GPM/LIT)	RPM MIN/MAX	CURRENT (AMPS)	VOLTAGE (VOLTS)
OPEN	3.30/12.5	2170/2300	3.5	12 VDC
10	3.00/11.3	2155/2200	5.0	"
20	2.67/10.1	2070/2120	6.4	"
30	2.38/9.0	2000/2030	7.5	"
40	2.14/8.1	1940/1970	8.3	"
50	1.86/7.0	1895/1930	9.1	"

*-SPECIFICATIONS SUBJECT TO CHANGE WITHOUT NOTICE.
-ALL DATA BASED ON TESTING WITH WATER.*